

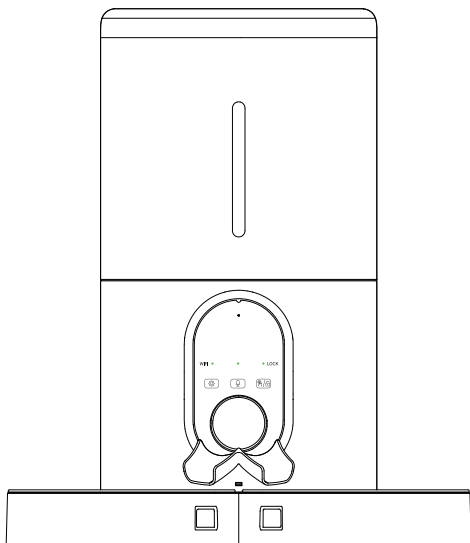

# Barn Automatic Dual Tray Pet Feeder

Model: FW50D / FW50D Plus



## USER MANUAL

\* Figures and illustrations in this User Manual are provided for reference only and may differ from actual product appearance.



# [CONTENTS]

<b>Product Specification</b> .....	1
<b>Assembly Guidelines</b> .....	2
Open the top cover .....	2
Put in desiccant.....	2
Food bowl installation .....	3
Pour in dry food .....	4
Connect power and install backup battery .....	4
<b>Operation interface</b> .....	5
<b>Buttons and indicator Lights</b> .....	6
<b>APP Usage Instructions</b> .....	7
Download WOpet APP .....	7
Register account .....	7
Add feeder device .....	7
Recommend feeding schedule based on pet profile .....	10
Extra Snack .....	12
<b>Cleaning and Maintenance</b> .....	13
Clean stainless steel bowl .....	13
Clean the food tank .....	13
Clean the turnplate .....	14
<b>FAQs</b> .....	15
<b>FCC Warnings</b> .....	17
<b>Have a Question For the Seller</b> .....	18
<b>Warranty Information</b> .....	19

# Product Specification

Model	FW50D	FW50D Plus
Capacity	4L	6L
Meals	10 meals per day	10 meals per day
Screen	LED	LED
One Portion	12 grams / 0.4 oz (20 portions at most per meal)	12 grams / 0.4 oz (20 portions at most per meal)
Food size	2-15mm(dry food only)	2-15mm(dry food only)
Pet size	Small/medium-sized dogs and cats	Small/medium-sized dogs and cats
Battery-powered supply	3 × alkaline D batteries (not included)	3 × alkaline D batteries (not included)
DC-powered supply	5V/1A	5V/1A
Operating temperature	-10°C - 55°C/14°F-131°F	-10°C - 55°C/14°F-131°F





Scan the QR code  
to set up the feeder

## Assembly Guidelines

### 1 Open the top cover

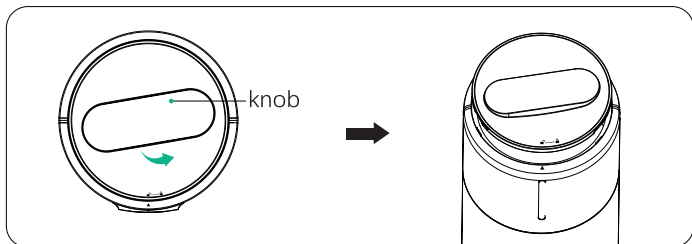

### 2 Put in desiccant

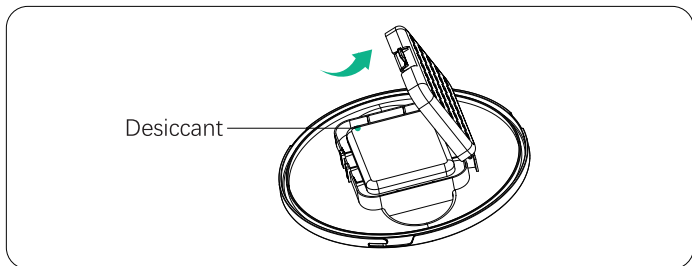

### 3 Food bowl installation

- Assemble the two food bowls in the direction of the arrow in the figure, as shown in Figure (a), and then insert ① into the food bowl

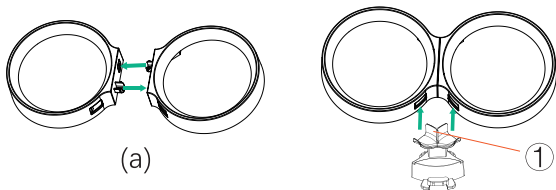

- Install food bowls and stainless steel bowls

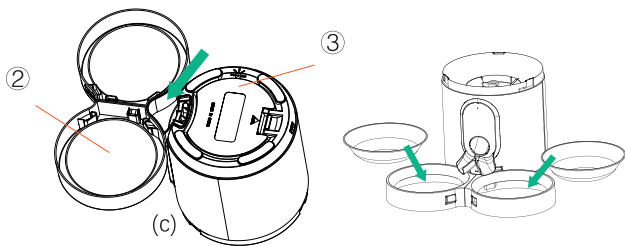

## 4 Connect the power supply and install the backup battery

- Open the battery cover upward according to the indicated position, put in 3 D-type batteries, and close the battery cover after insertion.
- Insert the TYPE-C power cord in the direction as shown in the figure.

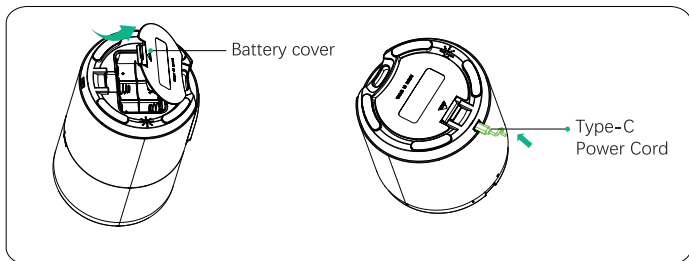





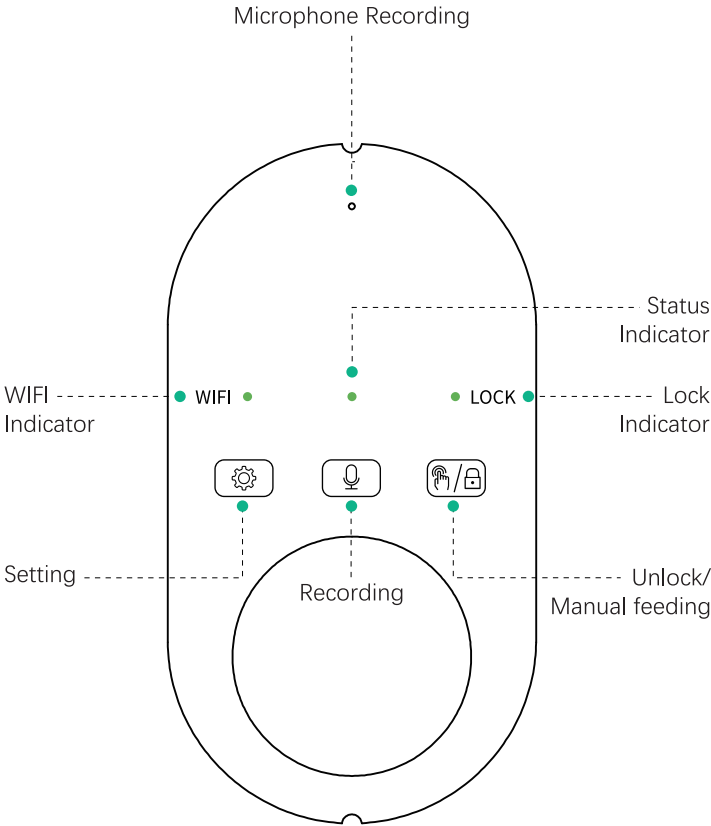

Notes: Although it is not necessary to use both modes at the same time it is recommended to use both modes in order to prevent the feeder from losing power during any power interruptions

# Operation interface



# Buttons and Indicator Lights

Button	Description	Function Instructions
 	Unlock/ Manual Feed	<ul style="list-style-type: none"><li>• Hold for 2 seconds to unlock/lock, indicator light goes out accordingly</li><li>• Click to feed one portion (in unlock state)</li></ul>
 	Record	<p>When unlocked, press and hold "Record" button. Begin recording after you hear a "beep" sound; release the button when finished. Two "beep" sounds indicate recording was successfully saved (supports up to 10 seconds)</p> <p>Status indicator:</p> <ul style="list-style-type: none"><li>• Green light: The feeding process is functioning correctly</li><li>• Red light: Out of food or another malfunction</li></ul>
 	Reset	<p>In the unlocked state, press and hold the "Settings" button for 5 seconds until you hear a beep. The green light will start flashing, indicating that the device will be restored to factory settings. Feed schedule cleared, recordings deleted, device re-enters pairing mode</p> <p>Note: WiFi disconnects automatically when the device is battery-powered, at which point the WiFi light turns off.</p>

# APP Usage Instructions

## 1 Download the WOpet app

- To download the WOpet app, scan the QR code or search “WOpet Life” in the Apple App Store® or Google Play Store.



Note: The mobile APP UI will be upgraded in the future, please refer to the actual interface for specific details.

## 2 Register account

Open the WOpet app. If you already have an account, tap Log In. To create a new account, tap Sign Up.

## 3 Add feeder device

Note: Enable Bluetooth and location services on your phone before adding a device.

- Click the "Set Up Device" button
- The app will automatically search for nearby devices. Click on the device you want to add and follow the on-screen prompts to complete the subsequent steps

- If the device is not found in the app, you can select it from the list - Add Device Manually
- After successfully adding the device, it will be displayed in the main page's device list

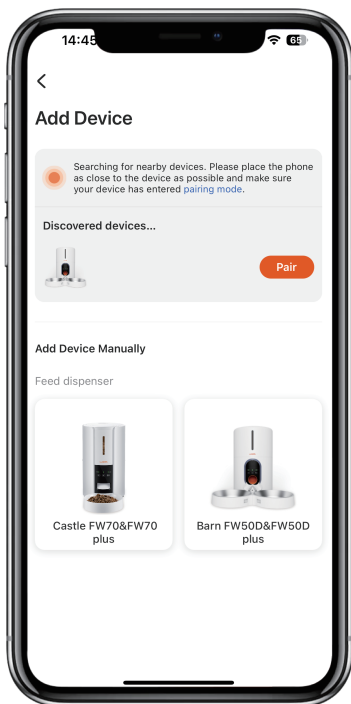
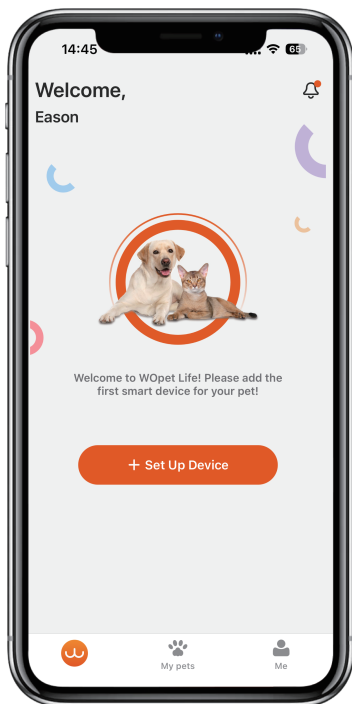

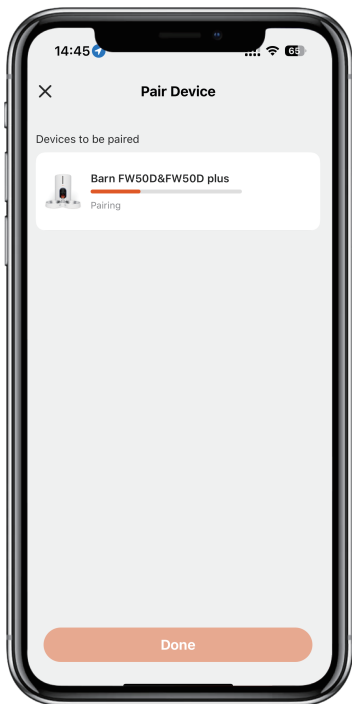

Note:

- The app supports both 2.4GHz & 5GHz Wi-Fi connections.
- To ensure normal WiFi connection and signal stability, please keep the device within 6 meters/19.7 ft of the router, without walls or other objects obstructing it.
- Network pairing is only supported in power supply mode, and app operations are not supported in battery power mode.



## 4 Recommend feeding schedule based on pet profile

- Select "My Pets" in the bottom navigation bar on the homepage; follow the on-screen instructions to create a pet profile, and then return.

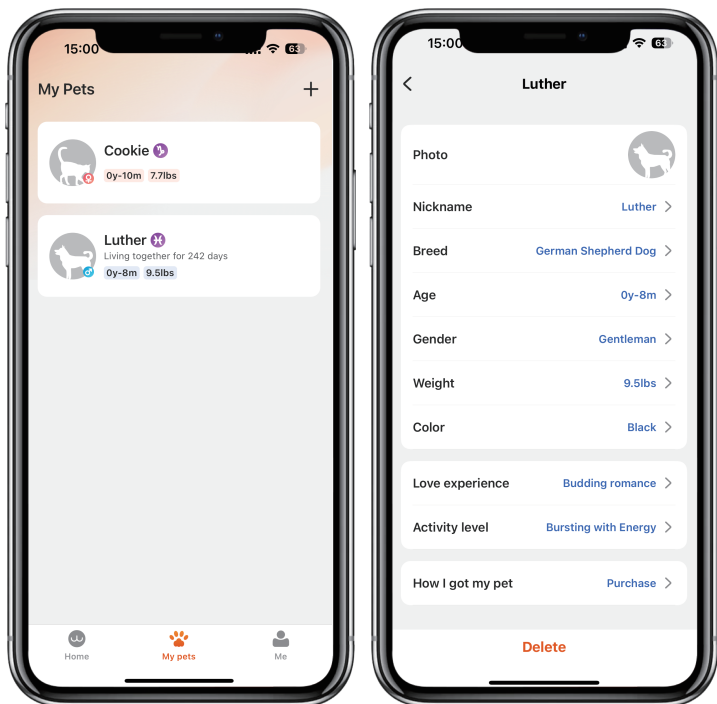

- Click on "Meal Schedule", select "Create for Pet" and follow the on-screen instructions to complete the plan setup

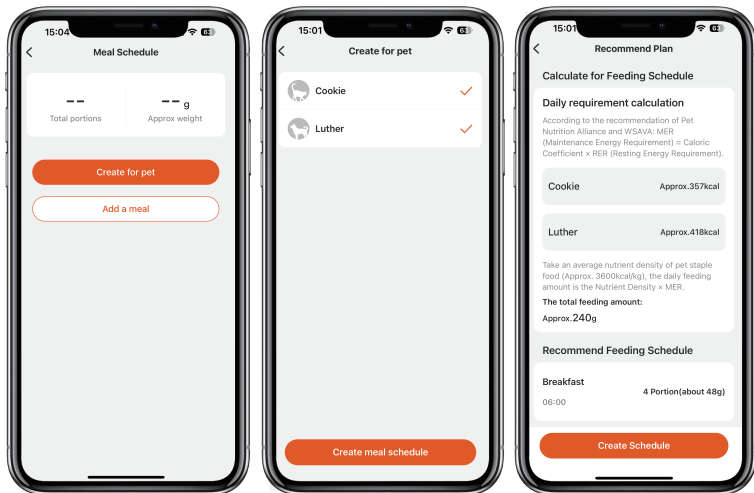

## 5 Extra Snack

Click on "Meal Schedule" to enter the feeding plan, click on "Add a meal", enter "Time, Label, Food Quantity" parameter settings, as shown in figures

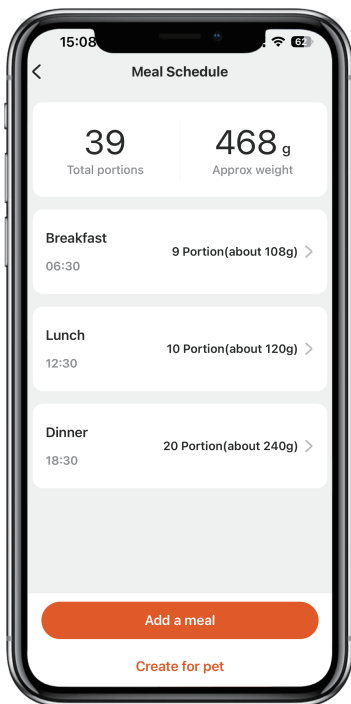
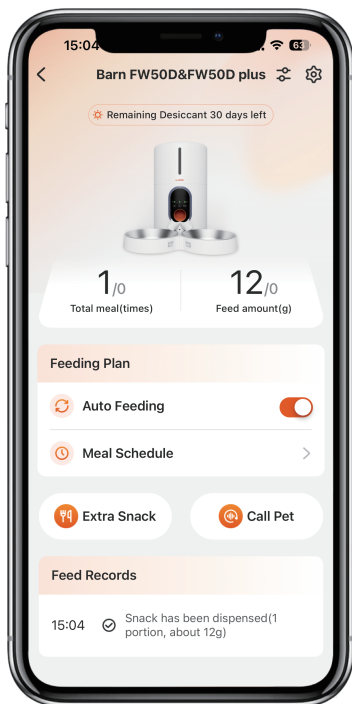

# Cleaning and Maintenance

## 1 Cleaning the stainless steel bowls

- Remove the stainless steel bowls and rinse them with water or place in the dishwasher for cleaning

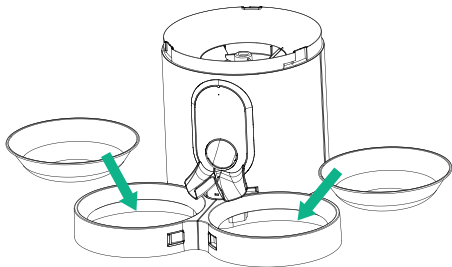

## 2 Clean the food tank

- Open the top cover and remove the desiccant

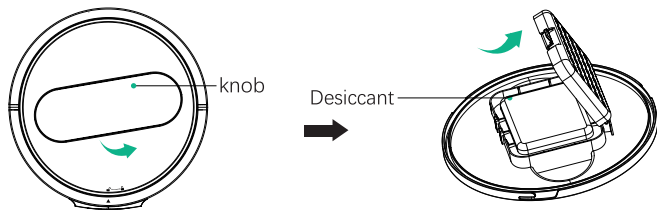

- Rotate the barrel counterclockwise, then lift up and take it out

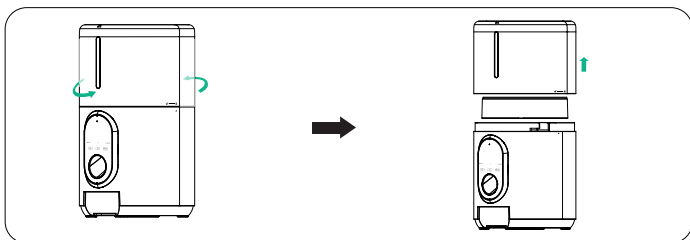

### **3** Clean the turnplate

- Turn counterclockwise to remove the turnplate

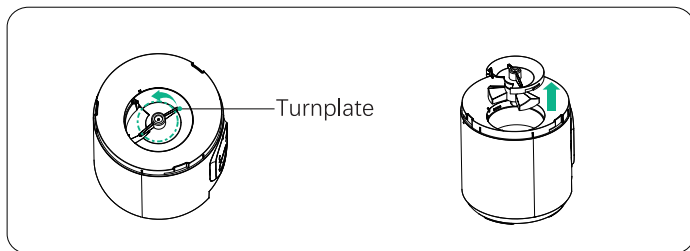

- After cleaning is completed, reinstall the turnplate and turn it clockwise to tighten.

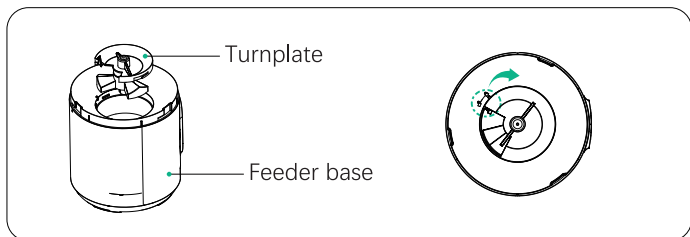

# FAQs

## **Q:The feeder cannot connect to Wi-Fi.**

- A:1. Check if the machine is powered correctly.  
2. Check if the account and password are correct, and enter the correct account and password (composed of letters, numbers, symbols, etc., 8~16 digits).  
3. Check if the feeder is powered by batteries. App operation is not supported when it is powered by batteries.  
4. Email our customer service for assistance.  
5. Reset the feeder.

## **Q:The feeder shows offline.**

- A:1. Keep the feeder within close range to the router (within 6m/19.7ft), without walls or other objects causing a weak signal.  
2. Reset the feeder.

## **Q:The operation buttons on the panel do not work.**

- A:Check if the child lock light is on. Exit child lock mode by long-pressing the unlock button for 2 seconds.

## **Q:The app operation does not dispense food properly.**

- A:1. Check if the power supply is normal, and if the battery power is sufficient when powered by batteries (indicated by the red light).  
2. Check if the food bowl is overfilled. If the working indicator light is flashing red slowly, you need to clean the food bowl.

3. Check if the feed bin is empty. If the working indicator light is flashing red quickly, you need to refill it.
4. Check if the rotor is jammed. If the working indicator light is constantly red, remove and clean the rotor to solve the jam.
5. Check if the food size is too large, causing a blockage. The feeder supports dry food with a diameter of 2-15mm/0.08-0.6inch.

**Q:The amount of food dispensed is varied.**

A:When food is just added to the machine, the first portion will be less. This is normal. After the third portion, a uniform amount will be dispensed.

**Any more questions, please email our support team:**



**support@wopet.com**



**Scan the QR code to set up the feeder**

# FCC Warnings

- Changes or modifications to this unit not expressly approved Non-compliance could void the user's authority to operate the equipment.

## Notes:

This equipment has been tested and found to comply with the limits for a Class B digital device, pursuant to Part 15 of the FCC Rules. These limits are designed to provide reasonable protection against harmful interference in a residential installation.

This equipment generates, uses and can radiate radio frequency energy and, if not installed and used in accordance with the instructions, may cause harmful interference to radio communications. However, there is no guarantee that interference will not occur in a particular installation. If this equipment does cause harmful interference to radio or television reception, which can be determined by turning the equipment off and on, the user is encouraged to try to correct the interference by one or more of the following Measures:

- Reorient or relocate the receiving antenna.
- Increase the distance between the equipment and receiver.
- Connect the equipment into an outlet on a different circuit from that to which the receiver is connected.
- Consult the dealer or an experienced radio/TV technician for help. Shielded interface cables must be used with the equipment in order to comply with the limits for a digital device pursuant to Sub part B of Part 15 of FCC Rules. Specifications and designs are subject to change without any notice or obligation on the part of the manufacturer



# Have a Question For the Seller

## 1.Find your order

Home

Your Order



Buy Again

Your Wish List

Your Account

Shop by Department >

## 2.Click “View order details”

### Your Orders

■ Product link

Buy it again >

Write a product review >

View order details >

## 3.Click the Seller name

### View order details

Order#

Order Total

### Shipped

■ Product link

Qty: 1

Sold By: Seller

## 4.Click “Ask a question”

### BRAND

Have a question  
for the seller?

Ask a question

- Gifted parts, replacements, consumable products are not covered by the 2-year warranty
- Manufactures' warranties may not apply in all cases, depending on factors such as use of the product, where the product was purchased, or who you purchase the product from.
- Please review the warranty carefully, and contact the manufacture if you have any questions.

## Warranty Information

- If you have any problems when using our products, please send an email to the mailbox: [support@wopet.com](mailto:support@wopet.com)
- 30 days free Return & Replacement
- Standard Warranty: 1-Year product Warranty  
2-Year Warranty Application: Please scan the QR code to finish the registration form on our official website within 30 days after you received the items.







wopet

Boundless Love for Pets