



WOPET

INSTRUCTIONS

WOpet Brook Stainless Steel Drinking Fountain

D30



【CONTENTS】

Product specifications and appearance	1
Key features	2
Assemble and use	5
Disassemble and clean	7
Important notes	9
FAQs	10
FCC warnings	12

Please read these instructions carefully before use

Thank you for choosing this WOpet intelligent product. In order to guarantee your personal and material safety, please read these instructions carefully before using our product. Under no circumstances shall WOPET be liable to pay compensation or damages to any person for any loss, injury, or damage, unless it's explicitly stipulated in law, whatsoever occasioned by this product or as a result of not following

► Product specifications and appearance

- Water outlet mode: Spout jet / little flower fountain
- Product dimensions: L288mm x W231mm x H94mm
- Power supply: DC5V (Adapter for DC5V-1A or 2A is recommended)
- Filter: Replaceable Carbon Filter
- Product weight: 0.6 kg
- Water storage capacity: 2.0 L (67 oz)
- Consumed power: 1 W



► Key features

- Little flower fountain type water outlet

(Natural and quiet)



- For dogs to enjoy interesting and comfortable drinking.



● **Spout jet type water outlet**

(fresh and oxygen-rich)



- For kittens to enjoy fresh and oxygen-rich flowing water.



- ① Simple and high-end design, suitable for the water-drinking habits of various pets.
- ② Spout jet and fountain type water outlet to cater to the preferences and demands of different pets.
- ③ Totally enclosed design is safe and stable, and will effectively prevent pets from overturning.
- ④ Food-grade filter and built-in and replaceable activated carbon filter element effectively filter impurities.
- ⑤ Super-easy dismounting and cleaning provide comfortable experiences for users.
- ⑥ Ultra-large top-level water area increases the water storage so continuing to work in occasional power outages.
- ⑦ 304 stainless steel makes the product safe and durable and it conforms to the United States and EU safety standards.
- ⑧ Brand new water storage and flow system make it super clean and rich in ozone, which improves water-drinking quality for your pets.

► Assemble and use

- 1 Open the top bowl by pulling the lifting handle as shown in the picture.

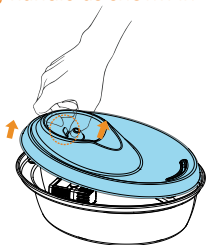
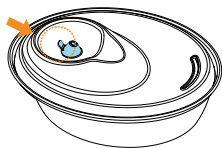

- 2 Install the water pump at the location as shown in the picture.

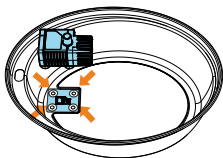

- 3 Install the thread jamming slot as shown in the picture and appropriately adjust the length of the water pump.

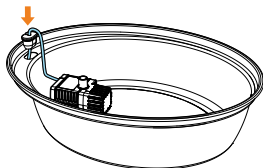

4 As shown in the picture, connect the DC connector.

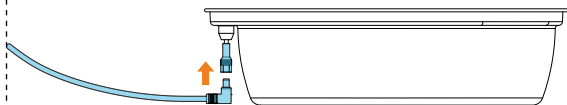

5 Add appropriate water between "min" and "max".

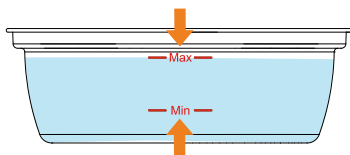

6 Install the top bowl.

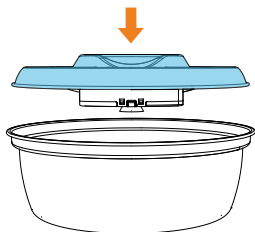

7 Plug-in the adapter.

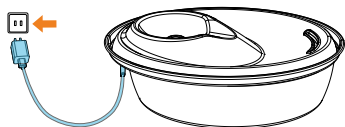

► Disassemble and clean

1 Disassemble the fountain

a.



- ① Take out the drinking basin by pulling the lifting handle as shown in the picture.

b.

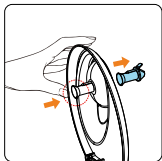

- ② Take out the outlet for cleaning or replacing according to the method shown in the picture.

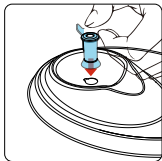

c.

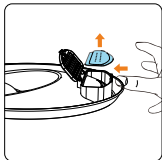

- ③ Press to open the cover and take out the filter. It is recommended to replace it once a week.

d.

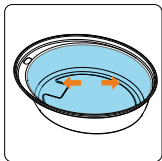

- ④ Take out the water pump to clean the internal wall of the water storage basin.

Note: D30 stainless steel pet fountain has designed two modes for different pets, the default installation of the product is spout jet. Please switch to fountain type according to the method shown in the picture b.

2 Clean the internal wall of the water pump

- ① Take down the protective cover, adjusting cover and rotor successively.
- ② Clean any foreign material inside it.
- ③ It is recommended to clean it once a week.

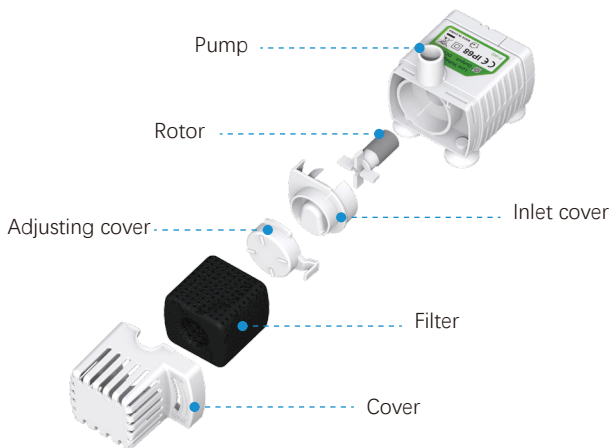

3 Adjust the water flow rate

- ① In the pump, Max means increasing the water outlet, and Min decreasing.
- ② The default setting is for Max flow.

► Important notes

1. Please add water immediately or stop using in the event that the water level of the fountain is lower than the water pump.
2. Please keep the power adapter out of reach of pets so as to prevent them from touching or chewing it.
3. Indoor use only. Please unplug the power line when cleaning, and please note that the adapter cannot be cleaned and must be kept away from water.
4. Cellphone adapters can be used (all DC5V are applicable).
5. Please keep the fountain away from socket and make sure the adapter and socket are higher than the fountain to prevent water damage.
6. For any questions, please contact the distributor or manufacturer.

▶ FAQs

■ Why is the noise of the water pump higher than before?

A: It is possible that the water level is too low, please add more water.

B: It is possible that there is foreign matter such as hair on the blades.

Please disassemble the water pump and have it cleaned.

■ How often should the fountain be cleaned?

A: It is recommended to clean it once or twice a week. Please do not use detergent when cleaning, only use a cotton cloth with water.

■ Is it normal if the adapter heats up when the fountain is running constantly?

A: It is normal for it to get slightly hot. It is within the safety range, and will not cause any damage to the fountain.

■ Is it safe for a water pump to operate on a long term basis and what is its power consumption?

A: The fountain runs on a safe voltage, the same as a cellphone charger.

It is absolutely safe for people and pets.

B: The fountain is extremely power efficient. It will consume no more than 1 Kilowatt-hour operating 24 hours every day in a month.

■ What is the fountain made of? What is the material of the filter?

A: The fountain is made of 304 food-grade stainless steel, which conforms to United States and EU safety standards. The material of the filter is Premium Activated Carbon.

Note: It's recommended to replace the filters every 2-4 weeks.

▶ FCC warnings

WARNING:

Changes or modifications to this unit not expressly approved. Non-compliance could void the user's authority to operate the equipment.

NOTE:

This equipment has been tested and found to comply with the limits for a Class B digital device, pursuant to Part 15 of the FCC Rules. These limits are designed to provide reasonable protection against harmful interference in a residential installation.

This equipment generates, uses and can radiate radio frequency energy and, if not installed and used in accordance with the instructions, may cause harmful interference to radio communications. However, there is no guarantee that interference will not occur in a particular installation. If this equipment does cause harmful interference to radio or television reception, which can be determined by turning the equipment off and on, the user is encouraged to try to correct the interference by one or more of the following measures:

- Reorient or relocate the receiving antenna. ·Increase the distance between the equipment and receiver.
- Connect the equipment into an outlet on a different circuit from that to which the receiver is connected.
- Consult the dealer or an experienced radio/TV technician for help.

Shielded interface cables must be used with the equipment in order to comply with the limits for a digital device pursuant to Subpart B of Part 15 of FCC Rules. Specifications and designs are subject to change without any notice or obligation on the part of the manufacturer.



www.wopet.com



support@wopetshop.com



<https://www.facebook.com/wopetworld>