



Even Automatic Feeder

Model: FT80D



USER MANUAL

[CONTENTS]

Product Specifications	1
Feeder Assembly	3
Install the food tank	3
Install the bowls	4
Load in desiccant	6
Install the lid	7
Plug in the power	8
Feeder panel introduction	9
Buttons Overview	10
Setting Guideline	11
Set the current time	11
Set feeding meals	13
Cancel feeding schedule	16
Recording	16
Manual feeding	17
Reset to Factory Default	17
Feeder cleaning	18
Important notes	19
FAQs	20
FCC Warnings	21
Warranty Information	23
Have a Question For the Seller	26

Product Specification

Model	FT80D
Capacity	8L
Meals	4 meals per day
Screen	LCD screen
One portion	12grams(8 portions max per meal)
Food size	2- 12mm(dry food only)
Battery-powered supply	3× alkaline D batteries (not included)
DC-powered supply	5V/1A
Operating temperature	-10°C - 55°C/14°F-131°F
Dementions	23.5*23.5*33.5cm/9.3×9.3×13.2 inches
Product weight	2.4kg/5.29lbs

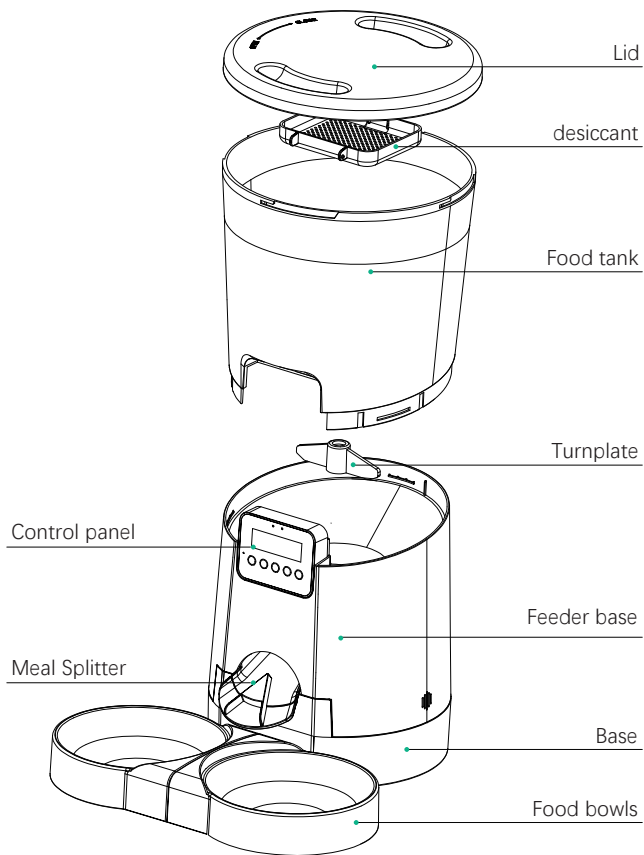

Feeder Assembly

1 Install the food tank

- Align the feeder base with the tank and install the feeder as indicated by the arrow shown.

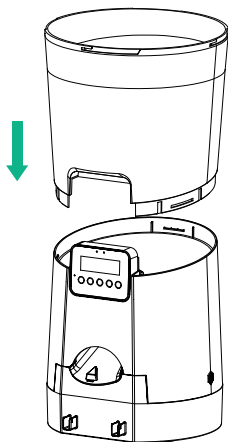

2 Install the bowls

2.1 Single food bowl

- Insert (1) one bowl into the main base, as hown in (2) and (3).

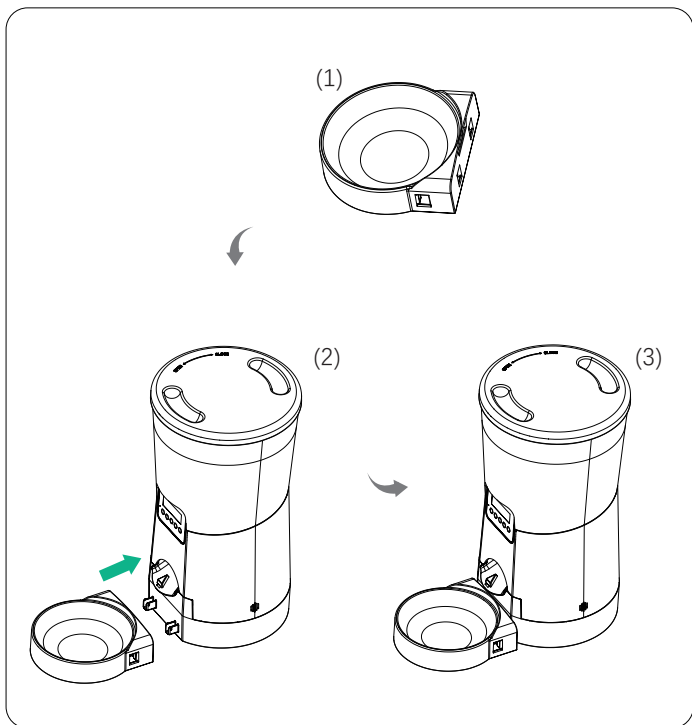

2.2 Dual food bowls

Step 1: Install the bowls

- Put the two food bowls together in the direction of the arrow shown in figure (4), and then insert the food bowl into the main base as shown in (5) and (6).

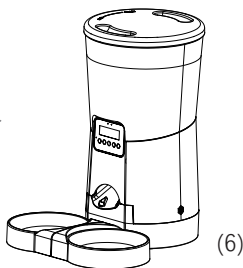
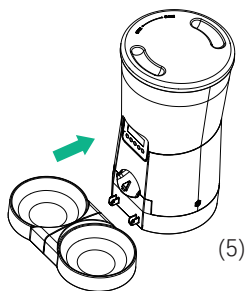
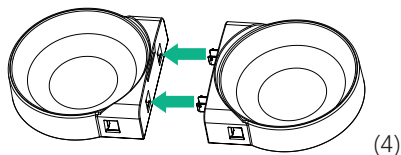

Step 2: Insert the meal splitter

- Install the meal splitter as indicated by the arrow as shown in (7), from top to bottom in place as shown in (8).

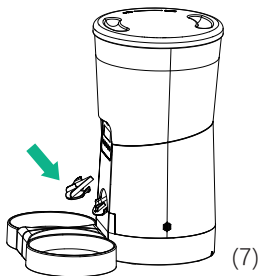

3 Load in desiccant

- Open the desiccant cap, put in the desiccant, and then close the desiccant cap.

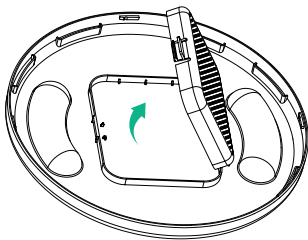

4 Install the lid

- First, align the lid to the tank and install from top to bottom, as shown in (9). Next, fit into place, then rotate the lid clockwise as shown in (10).

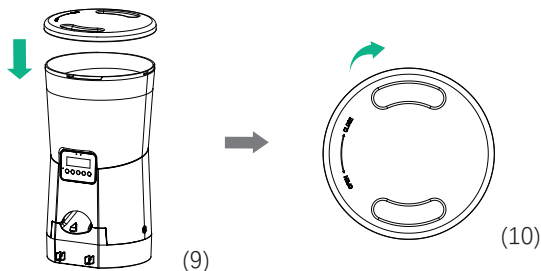

5 Plug in the power

- Step 1: Open the batteries cover, as shown in (11). Insert the power cable oriented, put the cable into the slot.

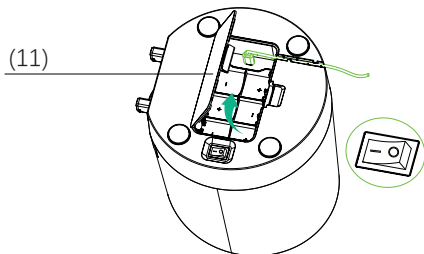

- Step 2: Install 3 new D cell, alkaline batteries.(NOT Included)



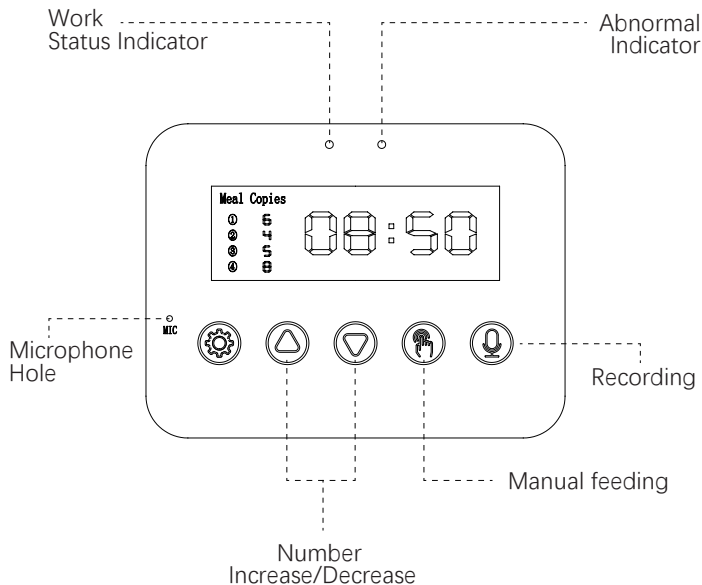

Note: Push the button switch to “I”. When the power is on, the green light lights up, which indicates that the power is normal.

Feeder panel introduction



Buttons Overview

Note: The screen will lock automatically after 2 minutes of non-use.
Hold  for 3s to unlock.





Button	Description	Operable Mode Function
	Set /Save Unlock button	<ul style="list-style-type: none">• Press to save and move to the next step• Press and hold for 3s to lock/ unlock other buttons and screen
	Number Increase button	<ul style="list-style-type: none">• Press to increase the value• Hold for digit increasing automatically
	Number Decrease button	<ul style="list-style-type: none">• Press to decrease the value• Hold for digit decreasing
	Manual button	<ul style="list-style-type: none">• Press to feed 1 portion
	Recording button	<ul style="list-style-type: none">• Hold for 3s and start recording after a beep is heard {max 10s}• Recording saved after a double beep is heard

Setting Guideline

Step 1 — Set the Current Time

1.1-Hour setting



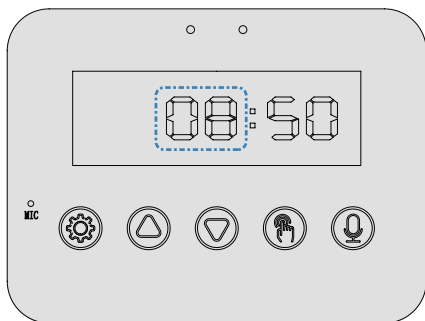

(MUST BE UNLOCKED)

Press and hold the  button for 3s until the LCD display lights up and enter the hour setting mode. The two hour digits will start to flash, press / to set the "hour". Hold / digits will automatically begin to increase/decrease until the desired time is displayed.

Note: In the setting state, the LCD light will turn off and exit the setting when there is no operation for more than 2min.



1.2-Minute Setting

After setting the hour, press the  button to save and enter the minute setting. Press / to set the "minute". Press the  button to save.

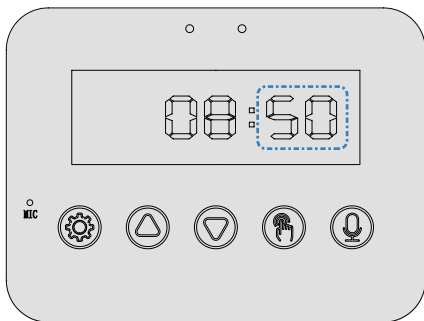



Step 2 — Set feeding meals

2.1-Set the copy of the first meal

(MUST BE UNLOCKED)

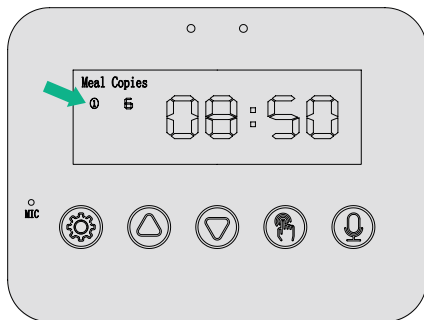
1. Press the  button to enter the copies setting of the first meal. At this time, the meal number labeled as the first meal "①" will lights up.



2. Press the  button to set the "copies". Then press the  button to save.

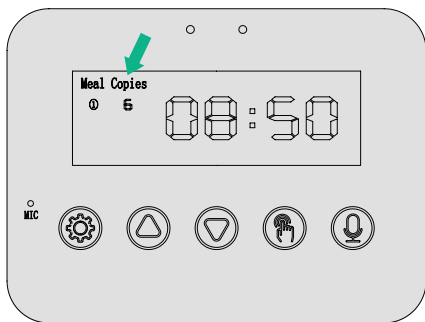

Note: The maximum number of copies is 8.

2.2-Set the time of the first meal

After setting the copies, press the  button to save. The feeder then enters the time setting mode. The setting method is the same method as setting the current time.

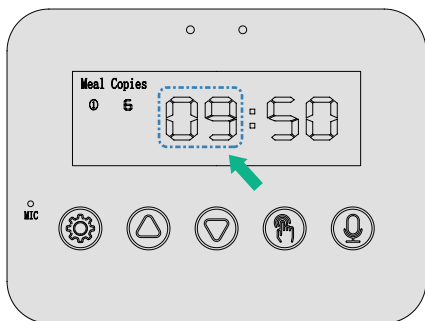

2.3-Set the 2-4 meals

After finishing setting the first meal, press the  button to save and the feeder then enters the setting mode of the second meal"②". Follow the same steps as setting the first meal. Repeat to set feeding schedules for the other meals. The maximum meal is 4.

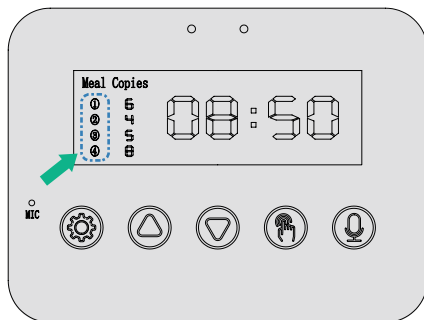

STEP 3— Cancel feeding schedule

Step 3.1

If you want to cancel the feeding of a meal, you just need to set the "copies" number to 0.

STEP 4— Recording

When not in the setting state(LCD lights off)

Press and hold the  button, it will make one "beep" sound.

At this time, speak loudly into the device's microphone, and it will record your voice. (max 10s) A double beep indicates recording is saved.

A recording will be played automatically when the recording is completed.



A recording will be played once when feeding.

Note: If you need to change the recording message, press the  button again to record.

STEP 5— Manual feeding

When not in the setting state (LCD light is off), press the  button to dispense 1 portion.

STEP 6— Reset to Factory Default

When not in the setting state (LCD light is off)
Press and hold /  at the same time for 3s, all settings will be cleared, and the feeder will be restored to factory settings and restart automatically.

Feeder cleaning

- Turn off the feeder, unplug the power adapter, and take out the batteries before cleaning.
- The lid, feeder tank, and turnplate can be disassembled to clean. Lift the material cylinder up, and then remove it to clean. Please use clean water or a soft detergent to clean. After cleaning, you must wait for the device to dry before using.
- The base and the exterior parts of the feeder body can be wiped with a dry cloth.

DO NOT PUT THEM INTO THE WATER FOR CLEANING.

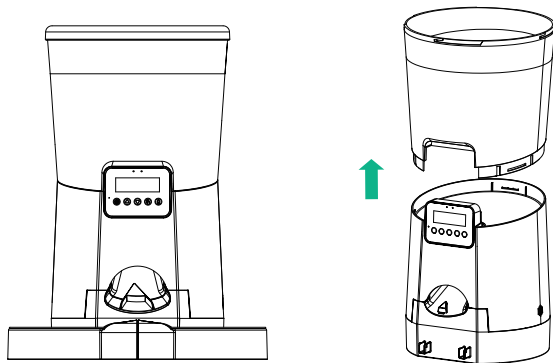

Important notes

- Low power reminder: The red alarm light will flash when the battery power is low. Please replace the battery regularly for normal use.
- Only for indoor use. It is best to keep the feeder against a wall to prevent the pet from knocking it down.
- Please check whether there is enough food in the feeder and add more when required.
- If not using the feeder for a long time, remove the batteries to avoid any electrolyte leakage.
- When the red alarm light is on persistently, the equipment has malfunctioned. Please check the status of the feeder.

FAQs

Q1: How many meals can be set per day?

A: 4 meals per day at most with 8 portions per meal. One copy is about 12 grams.

Q2: Why is the feeder is not dispensing food smoothly?

A: Check if there is food residual accumulation of food in the outlet. Please clean the feeder regularly to prevent food blockages.

Note: The feeder is suitable for dry food only, and food under 12mm is ideal.

Q3: Why can I not wake up/Lockdown/Reset the feeder?

A: Try unplugging and plugging in the feeder, and try again.

Q4: How long will the batteries last?

A: Put in the three-D cell batteries. They will last for about 30 days.

Note: Batteries are designed as back-up power, and are not recommended to be used in the long run.

Q5: How can I change the recording?

A: Press and hold the "REC" button to re-recording and it will automatically replace the previous recording.

Any more questions, please email our support team:



support@wopet.com



FCC WarningsFCC

- Changes or modifications to this unit not expressly approved.

Non-compliance could void the user's authority to operate the equipment.

Notes:

This equipment has been tested and found to comply with the limits for a Class B digital device, pursuant to Part 15 of the FCC Rules. These limits are designed to provide reasonable protection against harmful interference in a residential installation.

This equipment generates, uses and can radiate radio frequency energy and, if not installed and used in accordance with the instructions, may cause harmful interference to radio communications. However, there is no guarantee that interference will not occur in a particular installation. If this equipment causes harmful interference to radio or television reception, which can be determined by turning the equipment off and on, the user is encouraged to try to correct the interference by one or more of the following Measures:

- Reorient or relocate the receiving antenna.
 - Increase the distance between the equipment and receiver.
 - Connect the equipment into an outlet on a different circuit than the one the receiver is currently connected.
 - Consult the dealer or an experienced radio/TV technician for help.
- Shielded interface cables must be used with the equipment in order to comply with the limits for a digital device pursuant to Sub part B of Part 15 of FCC Rules. Specifications and designs are subject to change without any notice or obligation on the part of the manufacturer.

Warranty Information

1 NON-TRANSFERRABLE LIMITED WARRANTY

- ① To provide customers with a quality shopping and user experience, we guarantee to replace, issue a refund, provide acceptable solutions to any defective products (as the customers prefers) from the date of purchase up to 2 years.
- ② Proof of purchase must be provided (order number or receipt) when making a claim to our customer support center.
- ③ Warranty registration may be requested within a month since the date of purchase, by sending your order number to the mailbox: support@wopet.com
- ④ The warranty is not transferable. We only provide warranty services to buyers who purchased from our Amazon store and WOpet official website store and possess proof of purchase - not to any other purchaser or subsequent owner.

⑤ Price matching policy is not applicable. No price difference will be refunded.

⑥ The sellers are the responsible party. Amazon allows different sellers to sell the same product, so please confirm the seller by checking the order details before contacting us.

2 WHAT IS COVERED

- Receiving defective or used (proof needed) products;
- Receiving with missing parts;
- Item is defective under proper use.

3 WHAT IS NOT COVERED

- Purchase from non-amazon channels /non-WOpet official website store/other physical stores;
- Gift without proof of purchase;
- Tampering/abnormal use/accidental damage;
- Replacements and parts;
- Installation fee/labor fee;

4 MAKING A CLAIM

- If you have any problems when using our products, please send an email to the mailbox: support@wopet.com
- 30 days free Return & Replacement
- Standard Warranty: 1-Year product Warranty
2-Year Warranty Application: Please scan the QR code below to finish the registration form on our official website to get 2-Year in total warranty.

Note: Please finish the form within 30 days after you received the items.



Have a Question For the Seller

1.Find your order

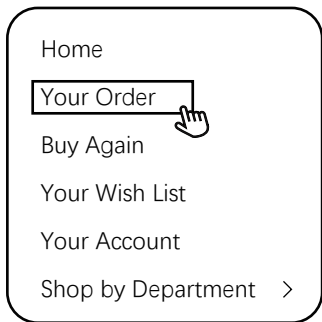

2.Click "View order details"



3.Click the Seller name



4.Click "Ask a question"



- Gifted parts, replacements, consumable products are not covered by the 2-year warranty.
- Manufactures' warranties may not apply in all cases, depending on factors such as use of the product, where the product was purchased, or who you purchase the product from.
- Please review the warranty carefully, and contact the manufacture if you have any questions.



wapet

Boundless love for pet